

VERY Portable Graphic Display & Exhibition Stand System

User Guide

1
Assemble Frame
with blue hookstuds at the top

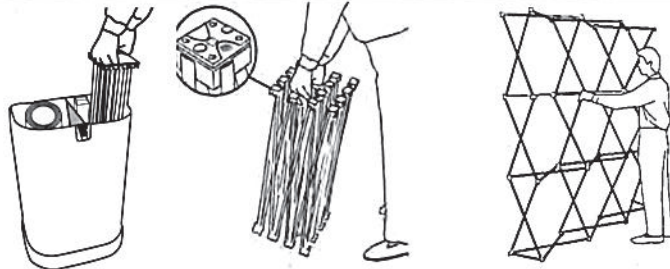

Magnetic EasyPopUp
Push the locking bars together until they attach

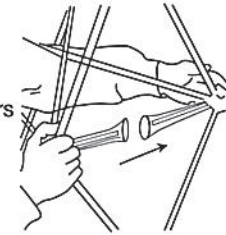

EasyPopUp
Push the locking arms together until they "click"

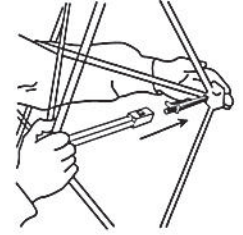

2
Fit Magbars



2b

Bottom Horizontal magbars to top holes of the bottom hub on straight systems and on outside curves

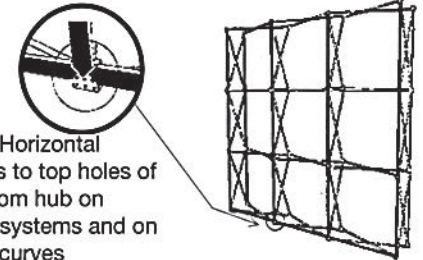

3
Panels



Panels are labeled on reverse. Sort them out at this point

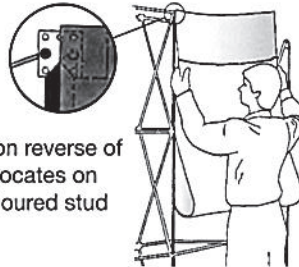

Hook on reverse of panel locates on the coloured stud

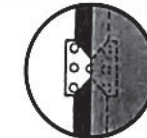

Align panel edges down centre of magnetic bar



End panels curve from front to back



4
Lights

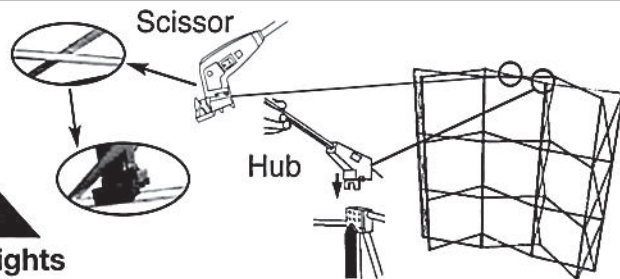

PopUp floor guide

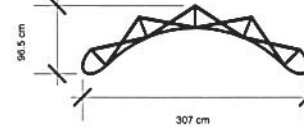
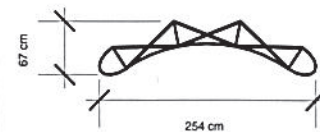

Case

PANEL PACKING IN



Roll 1 panel only graphics side out and place inside case. Once inside, unroll to touch the sides. Repeat with more panels. Reverse procedure to remove panels from case. Other components are stored in the remaining space available.